

LEGEND

	WORK AREA		COMPLETED FINAL PAVEMENT		DIRECTION OF TRAVEL
	TEMP. PAVEMENT THIS PHASE		EXISTING PAVEMENT MARKING TO REMOVE		PORTABLE BARRIER
	TEMP. PAVEMENT PREVIOUS PHASE				IMPACT ATTENUATOR
					WORK ZONE STOP LINE
					WORK ZONE CENTER LINE

• • • DRUMS

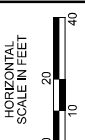

MAINTENANCE OF TRAFFIC PHASE 3
BEGIN PROJECT TO STA. 118+50

DESIGN AGENCY

CHA

DESIGNER
DTY

REVIEWER
BJA 09/12/22

PROJECT ID
113673

SHEET TOTAL
33 96

NOTES

1. PORTABLE CHANGEABLE MESSAGE SIGN (PCMS) TO BE PLACED ON WB U.S. 22 JUST EAST OF ITS INTERSECTION WITH S. WESTERN AVE. IN THE CITY OF CIRCLEVILLE. PCMS WILL GO ON SIDEWALK/BUFFER ZONE AREA.

PCMS SHALL UTILIZE ONE PHASE DISPLAYED CONTINUOUSLY. THE MESSAGE SHALL READ AS FOLLOWS:

PHASE 1: DO NOT STOP ON TRACKS

2. NO WATER BLASTING OF STRIPING OR DAMAGE TO OCCUR TO PAVEMENT BEYOND THE END WORK LIMITS (STA. 127+61.76).

PORTABLE CHANGEABLE MESSAGE SIGN SEE NOTE 1

TYPE A WARNING LIGHT



ROAD WORK AHEAD



W4-2L-30 (BLACK ON ORANGE) STA. 128+86

W20-1-36

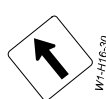

W4-H16-30 (BLACK ON ORANGE) STA. 127+39

END ROAD WORK

G20-2-36 STA. 128+83

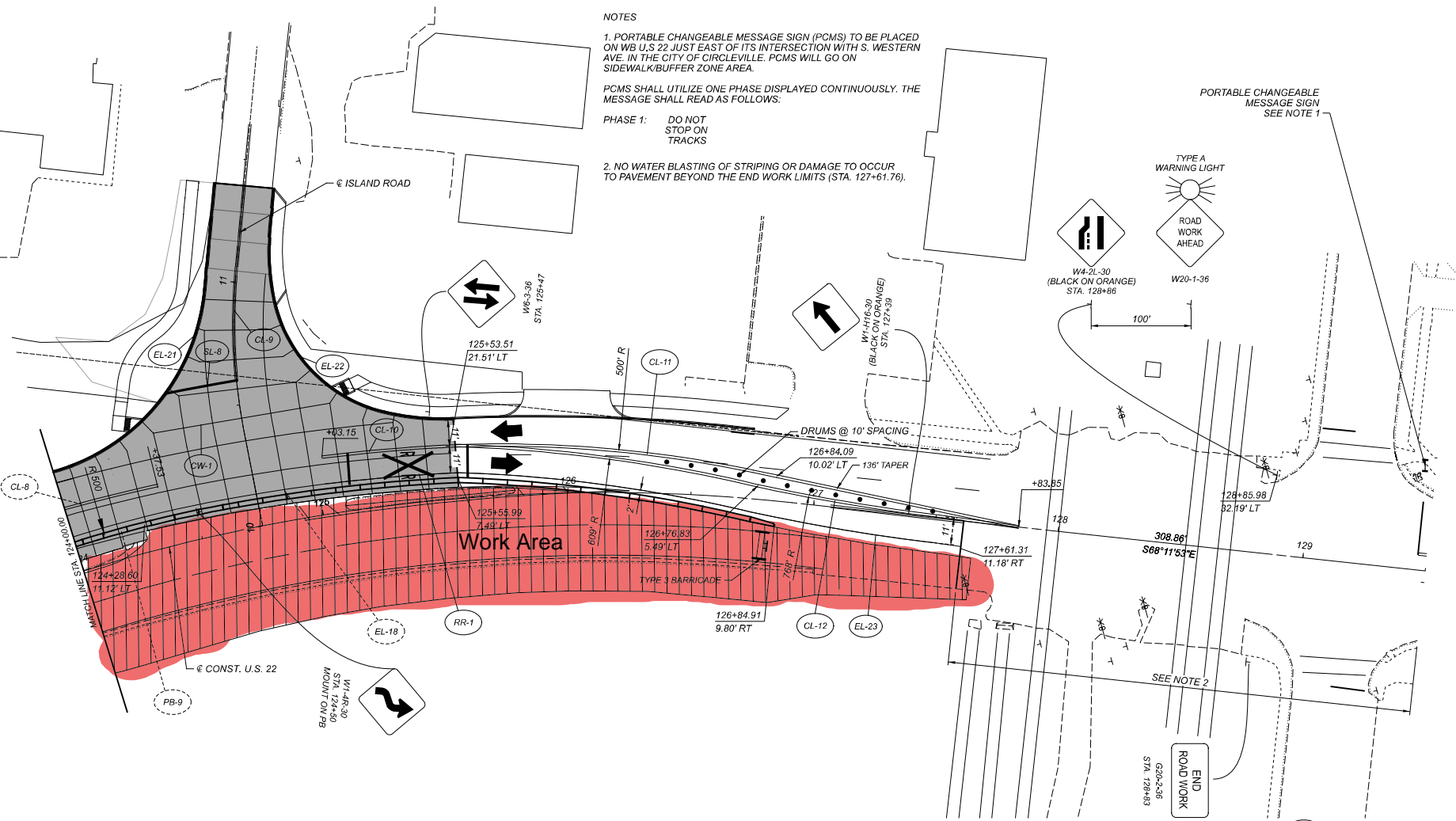

LEGEND

- WORK AREA
- COMPLETED FINAL PAVEMENT
- DIRECTION OF TRAVEL
- TEMP. PAVEMENT THIS PHASE
- EXISTING PAVEMENT MARKING TO REMOVE
- TEMP. PAVEMENT PREVIOUS PHASE
- DRUMS
- PORTABLE BARRIER
- IMPACT ATTENUATOR
- WORK ZONE EDGE LINE
- WORK ZONE STOP LINE
- WORK ZONE CENTER LINE

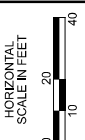

MAINTENANCE OF TRAFFIC PHASE 3
 STA. 124+00 TO END PROJECT

DESIGN AGENCY



DESIGNER	DTY
REVIEWER	BJA 09/12/22
PROJECT ID	113673
SHEET	TOTAL
35	96